

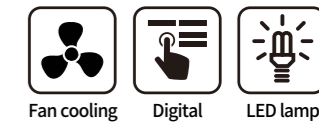

# UNDER COUNTER [BUN PAN]



# UNDER COUNTER [BUN PAN]



SUR15-2P  
SUF15-2P



BUN PAN TYPE



SUR18-3P  
SUF18-3P

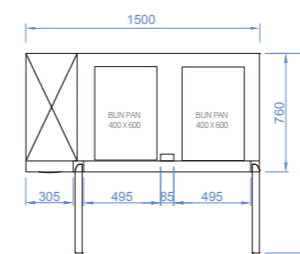

SUR15-2P  
SUF15-2P

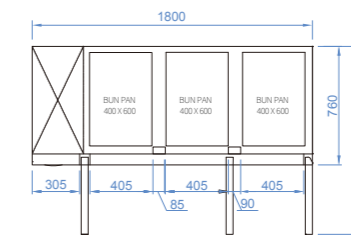

SUR18-3P  
SUF18-3P

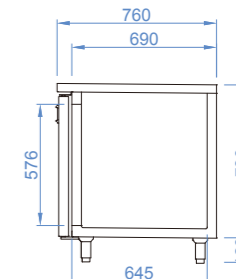

MODEL	SUR15-2P SUF15-2P	SUR18-3P SUF18-3P
Classification	Refrigerator / Freezer	
Cabinet dimension (WxDxH mm)	1500 x 760 x 850	1800 x 760 x 850
Capacity (ℓ)	425	538
Inner Temperature (°C)	-2~ 8 / -21 ~ -12	-2~ 8 / -21 ~ -12
Refrigerant	R-134a/R-404a	R-134a/R-404a
Insulation Type	Polyurethane / Cyclopentane + CFC Free	
Amps (A)	2.5/3	3/4.4
Voltage (V/Hz/Ph)	220 / 50 / 1	
Weight (Kg)	93	109
Power (W)	314/613	366/613
# of doors	2	3
Compressor (HP)	1/4 3/4	1/3 3/4
# of Shelves	2	3

DISPLAY PRODUCT

REACH-IN

UNDER COUNTER

ICE MAKER

SPECIAL MODEL

BAKING LINE

DISH WASHER