



## REACH-IN [GLASS DOOR]



SKIPIO

# REACH-IN [GLASS DOOR] FREEZER

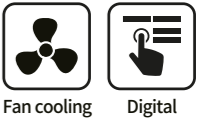

SFT25-1G

SFT25-2G

SFT45-2G

SFT45-4G

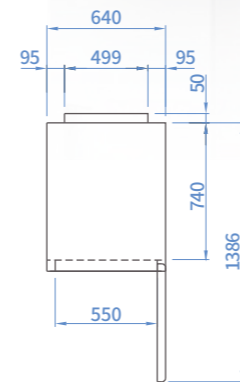

SFT25-1G  
SFT25-2G

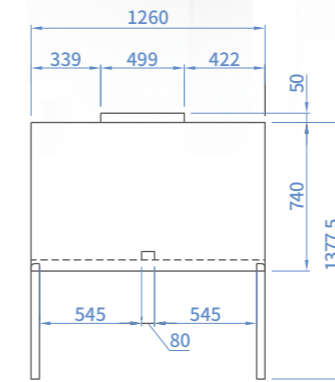

SFT45-2G  
SFT45-4G

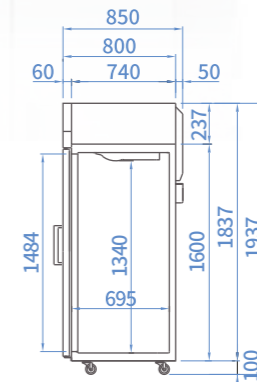

SIDE VIEW  
(Glass Door)

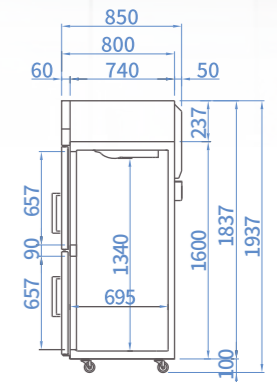

SIDE VIEW  
(Half Glass Door)

MODEL	SFT25-1G	SFT25-2G	SFT45-2G	SFT45-4G
Classification	Freezer			
Cabinet dimension (WxDxH mm)	640 x 850 x 1937	640 x 850 x 1937	1260 x 850 x 1937	1260 x 850 x 1937
Capacity (ℓ)	574	572	1215	1210
Inner Temperature (°C)	-21 ~ -12			
Refrigerant	R-404a			
Insulation Type	Polyurethane / Cyclopentane + CFC Free			
Amps (A)	4.5	4.5	8	8
Voltage (V/Hz/Ph)	220 / 50 / 1			
Weight (Kg)	95	95	170	170
Power (W)	660	660	976	976
# of doors	1	2	2	4
Compressor (HP)	6/7	6/7	2/3x2	2/3x2
# of Shelves	3	3	6	6

DISPLAY PRODUCT

REACH-IN

UNDER COUNTER

ICE MAKER

SPECIAL MODEL

BAKING LINE

DISH WASHER